

Kirk Park

Lake Michigan Coastal Greenway

PARK USER INFORMATION

No alcohol is permitted
No motor vehicles beyond parking lot
Bicycles are NOT allowed on trails
Dogs must remain on a leash at all times
Dog owners must clean up after their pets
No camping or fires
No hunting
All Ottawa County Parks rules & regulations are in effect on park property

LEGEND

-  PARKING AREA
-  LODGE
-  PICNIC SHELTER
-  PICNIC AREA
-  RESTROOMS
-  PLAY AREA
-  BARRIER FREE
-  VIEWING AREA
-  NATURAL SURFACE TRAIL
-  PAVED TRAIL
-  BOARDWALK
-  STAIRS
-  TRAIL INTERSECTION
-  TRAILS SHOWN IN MILES
-  10' TOPOGRAPHIC CONTOURS
-  SPOT ELEVATION

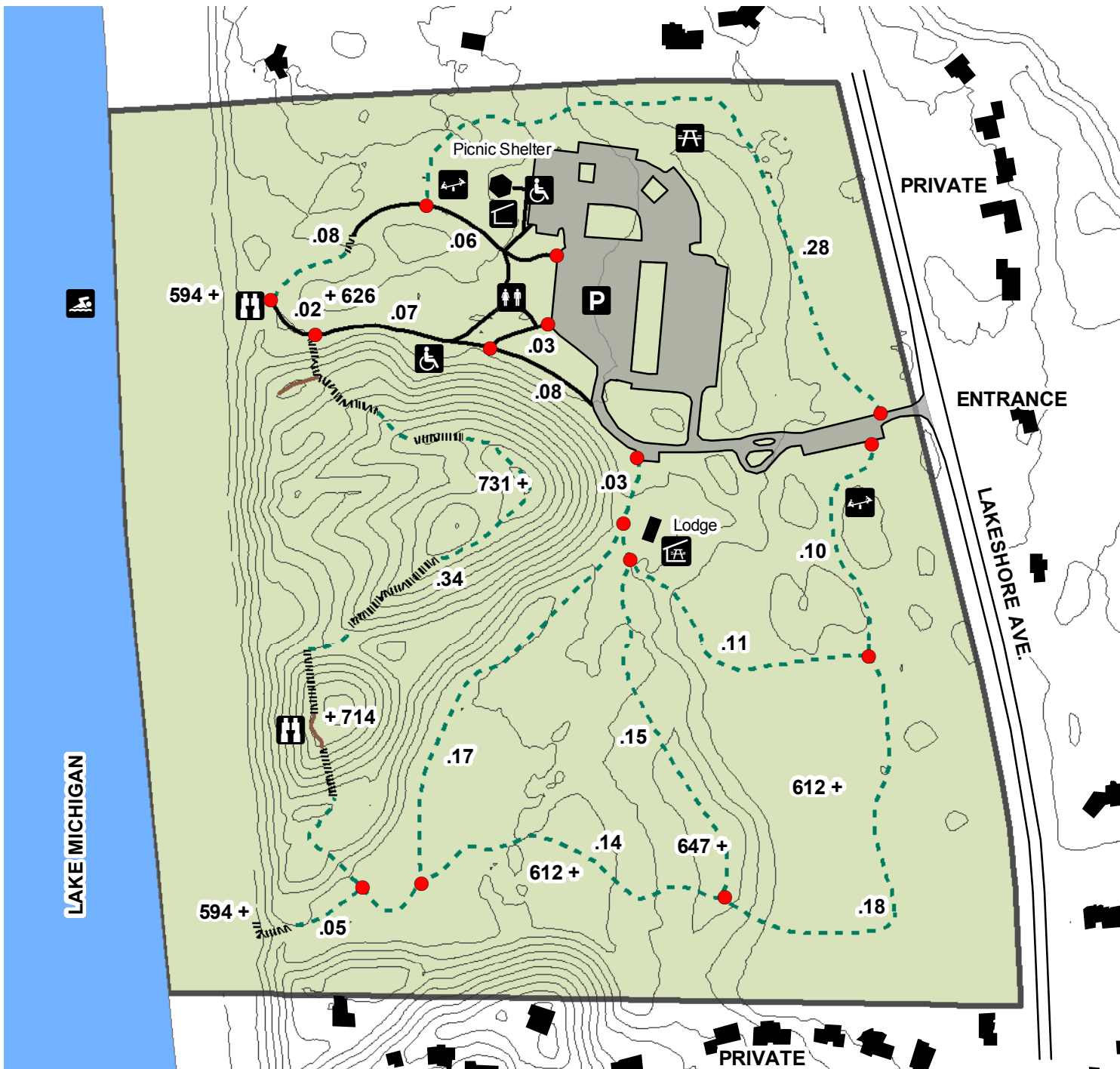

Ottawa County Parks & Recreation Commission

Kirk Park

9791 Lakeshore Drive
West Olive, MI 49460

Stretching along Lake Michigan's shoreline for over 1/3 mile, this park boasts 68 acres of sandy beach, high bluffs and wooded dunes. Nature trails with wooden stairways wind through the wooded dunes offering spectacular views of Lake Michigan. A paved path leads to a deck overlooking the beach and Lake Michigan. This is a popular park for swimming, sunbathing, picnicking and cross country skiing.

Note: Ottawa County provides NO LIFEGUARDS at parks with swimming facilities.

Facilities

- Picnic shelter (reservable)
- Kirk Park Lodge (reservable)
- Lake Michigan overlook deck
- Picnic Tables and grills
- Children's Playground
- Hiking and ungroomed cross country ski trails
- Horseshoe pit
- Modern rest rooms (closed in winter)

** Barrier free facilities include picnic shelter, restrooms, some picnic tables and grills and a trail to the Lake Michigan overlook deck.*

Park Hours

Kirk Park is open year 'round at the following times:

March 1 through October 15 - 7 a.m. to 10 p.m.
October 16 through the last day of February -
7 a.m. to 8 p.m.

Fees

Motor vehicle parking fees are in effect from Memorial Day weekend through Labor Day weekend. Fees are as follows:

- County Residents - \$5.00 Daily/
\$15.00 Annual
- Non-County Residents - \$7.00 Daily/
\$25.00 Annual
- Seniors (60 and older) - \$7.00 Annual
(Regular Daily Rates Apply.)

Directions

Located in Grand Haven Township along Lakeshore Avenue about 2 miles south of M-45 (Lake Michigan Drive).

For emergencies, call 911.

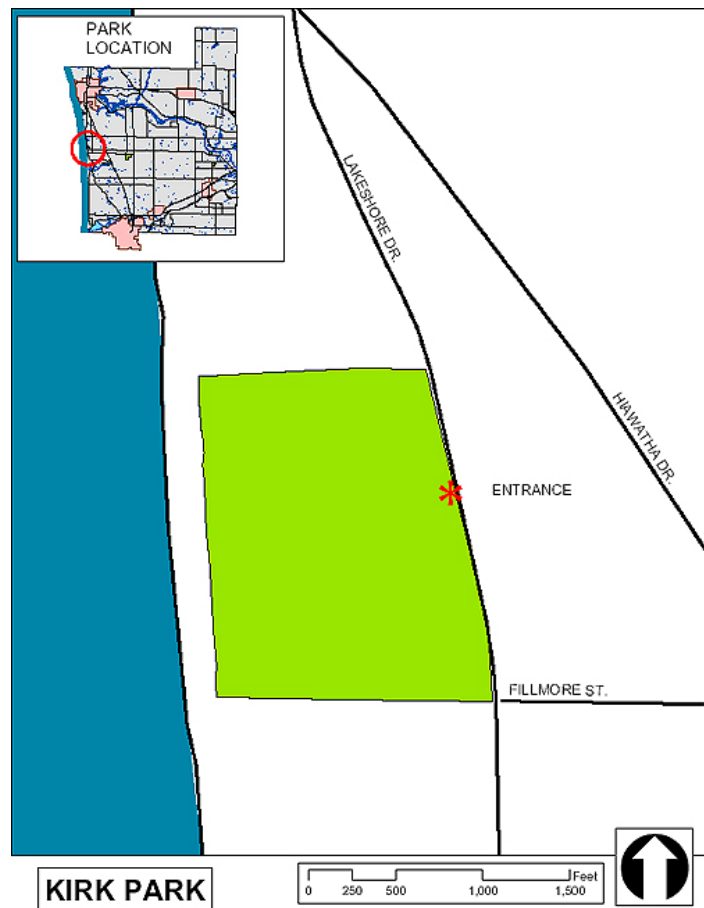

Ottawa County Parks & Recreation Commission
12220 Fillmore Street, West Olive, MI 49460
Phone: (616) 738-4810
Email: ocparks@miottawa.org
Website: <http://www.miottawa.org/parks>